

20 WINTHROP SQUARE

PROPERTY INFORMATION

20 Winthrop Square is a four story, first-class office building located in the heart of Boston's Financial District and is just steps away from bustling Downtown Crossing. The address overlooks one of Boston's newest and most dynamic multi-use development sites, the Winthrop Center tower. A tastefully decorated lobby features bronze elevators and gold accents and the street level is occupied by Rockland Trust and various other retail and banking establishments. 20 Winthrop Square is the headquarters of A.W. Perry, Inc. and management is on site providing superior service to building tenants. Tenants have 24-hour access and the lobby is attended by a security guard during business hours.



LEASING OPPORTUNITIES

- Floor: **2** | Size: **6,000 SF**
Available: **Summer 2023**
- Floor: **3** | Size: **6,000 SF**
Available: **Summer 2023**
- Floor: **4** | Size: **6,000-8,896 SF**
Available: **Summer 2023**

FLOOR 2 VIRTUAL TOUR

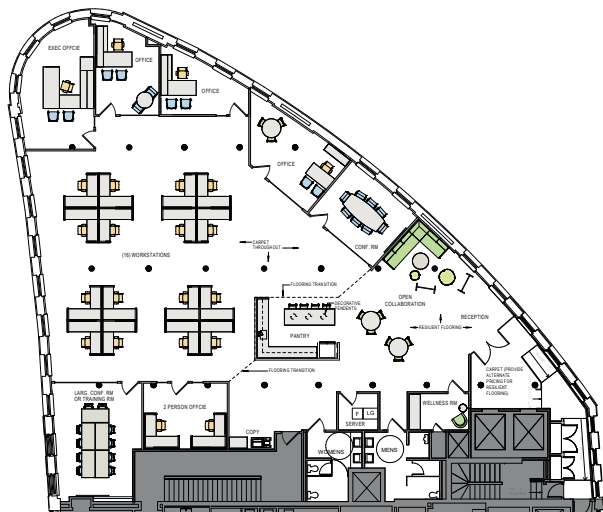
2nd Floor | 6,000 SF**3rd Floor | 6,000 SF****BUILDING INFORMATION****Commuter Paradise**

- Walk Score® 96
- Transit Score® 100

**Neighborhood Amenities**

- Retail
- Restaurants & Dining
- Entertainment

**Heart of Boston**

- Financial District
- Downtown Crossing

4th Floor | 6,000 - 8,986 SF